



Jim Jean Real Estate



1-800-722-5326

4131 NW 28th Lane, Suite 1, Gainesville, FL 32606 ♦ www.JimJean.com ♦ Cell: 352-339-4487

Bakersville Directions

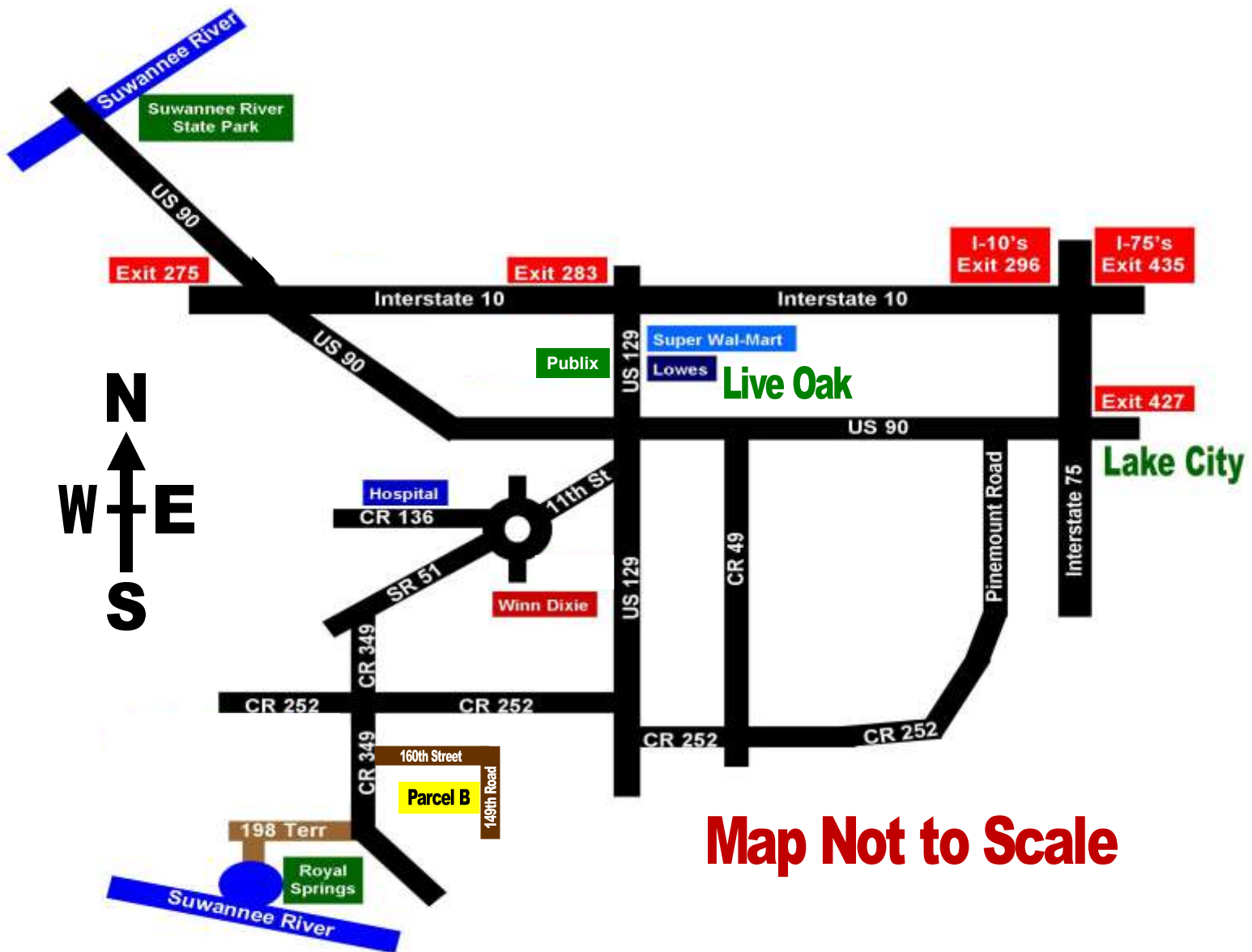

Map Not to Scale

Directions to Bakersville - Parcel B

1. Take Interstate 10 to Exit 283 (14 miles West of Interstate 75)
2. Take Exit Ramp to US-129
3. Turn LEFT onto US 129 South (Go approximately 4 miles to 11th St SW / SR 51 on your RIGHT)
4. Go around the traffic circle and continue on SR 51 towards Mayo (Go 5.5 miles to CR 349 on your LEFT)
5. Turn LEFT onto County Road 349 and go 1 mile to 160th Street on your LEFT.
6. Turn LEFT onto 160th Street and go 1/2 of a mile and the road will make a sharp RIGHT turn and now become 149th Road. Continue on 149th Road for 1/10 of a mile to Parcel B on your RIGHT.

Address of Parcel B is: 16025 149th Road, McAlpin, FL 32062