



Jim Jean Real Estate



352-339-4487

4131 NW 28th Lane, Suite 1, Gainesville, FL 32606 ♦ www.JimJean.com ♦ Cell: 352-339-4487

The Timbers – Estate 13 Sales Plat

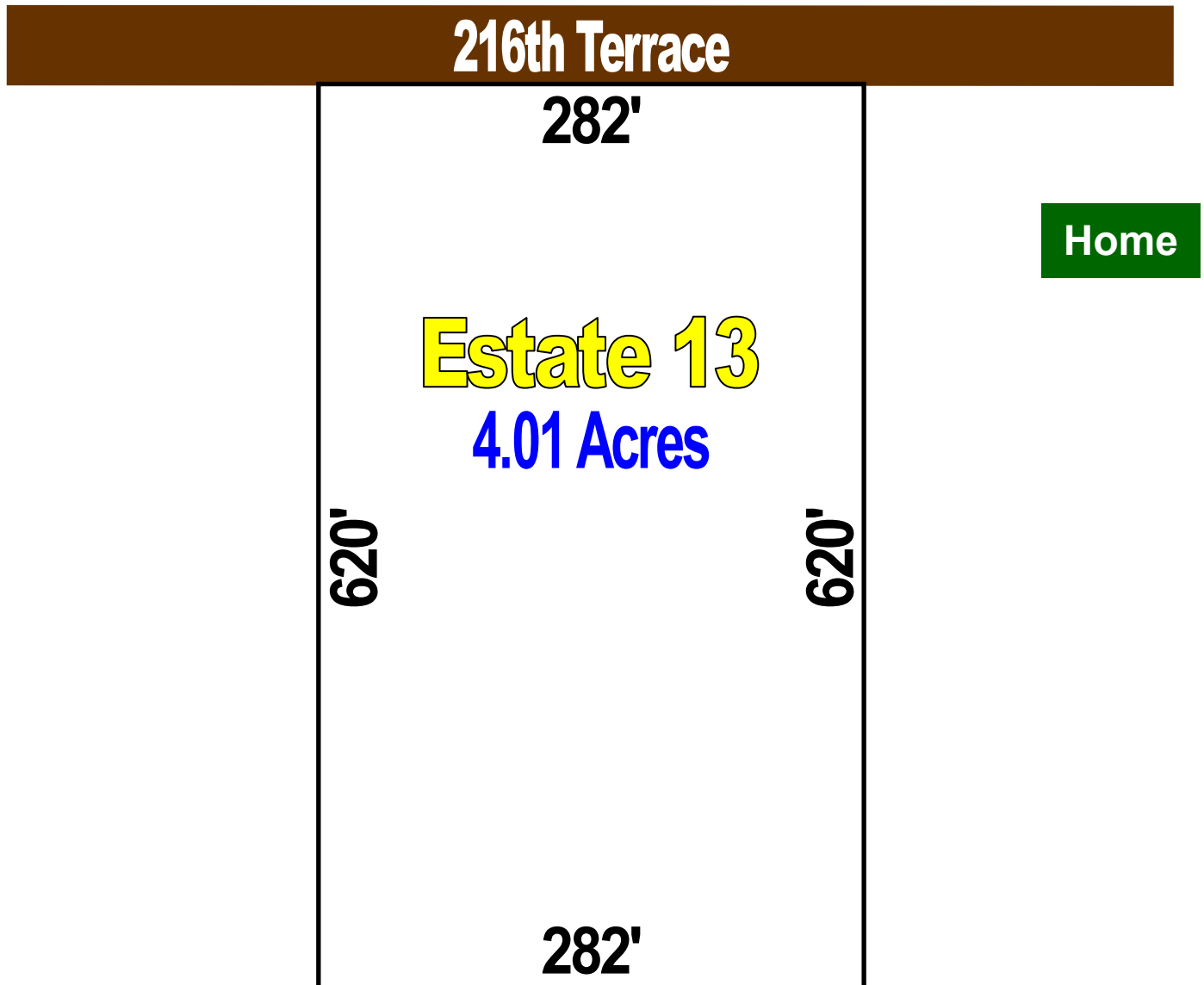

Automatic, Non-Qualifying Seller Financing is available with **NO** Pre-Payment Penalties

Estate	Acreage	Sales Price	Down	Monthly	Rate	Term
13	4.01	\$69,995	\$6,995	\$550	9.50%	25 Years