

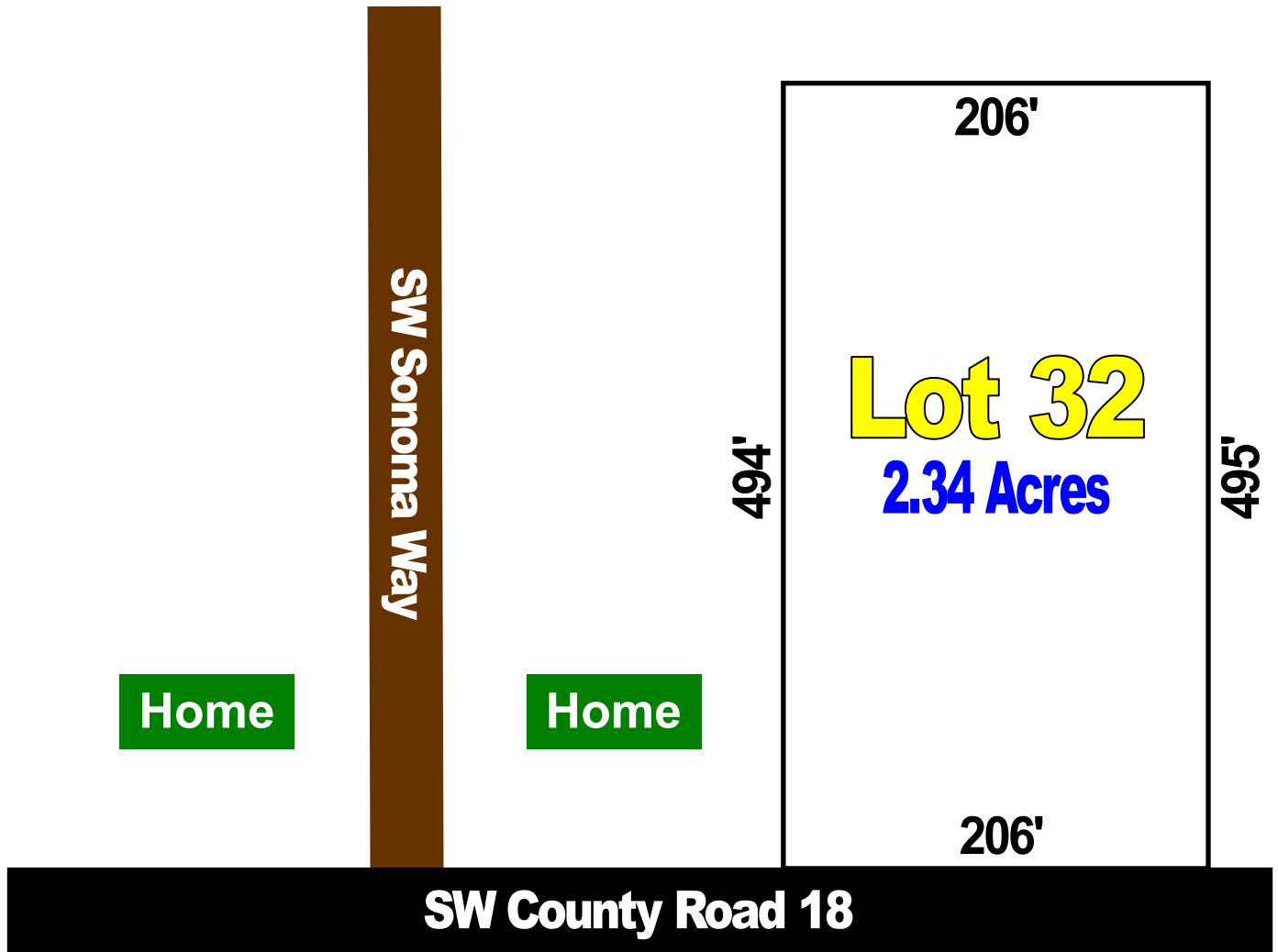

Quail Ridge Sales Plat



*Refer to recorded plat for survey details

Map Not to Scale

Automatic, Non-Qualifying Seller Financing is available with **NO** Pre-Payment Penalties

Estate	Acreage	Sales Price	Down	Monthly	Rate	Term
32	2.34	\$69,995	\$9,995	\$525	9.50%	25 Years