

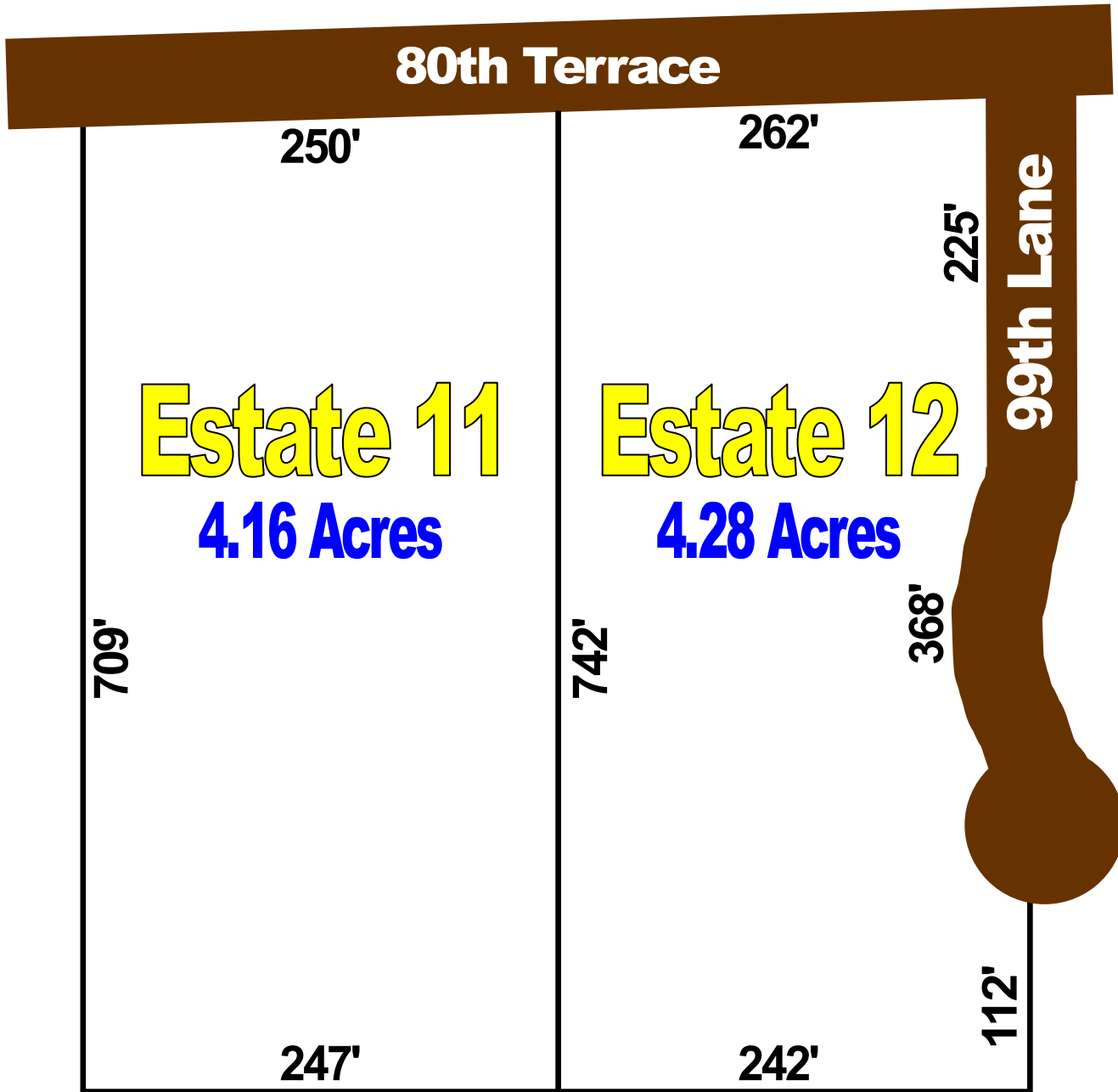

Hilldale Sales Plat



**Refer to recorded plat for survey details*

Automatic, Non-Qualifying Seller Financing is available with **NO** Pre-Payment Penalties

Estate	Acreage	Sales Price	Down	Monthly	Rate	Term
11	4.16	\$64,995	\$6,495	\$489	8.90%	25 Years
12	4.28	\$64,995	\$6,495	\$489	8.90%	25 Years